



Embassy of
The People's Republic of Bangladesh
Berlin, Germany

COM- Com-28/Heimtextil/25-50(507)

21.11.2025

Subject: **Quotation for construction of Export Promotion Bureau's (EPB) stand-in Frankfurt Messe for Heimtextil-2026 (January 13-16, 2026)**

Dear Madam/Sir,

Bangladesh Export Promotion Bureau (EPB) will participate in the forthcoming International Fair **Heimtextil- 2026 (January 13-16, 2026)**. A space of 33 sqm (11.00 m x 3.00 m) with 3 open sides at stand H14 in Hall 9.1 in the Frankfurt fairground (stand plan enclosed) has been allotted for EPB's joint stand.

Quotation for construction of the stand and supply of fixtures and furniture along with a design of the stand are invited which should reach Bangladesh Embassy, Kaiserin-Augusta-Allee 111, D-10553 Berlin on or before 12 December 2025 in a sealed envelope with the subject: Quotation for **Heimtextil** Fair-2026 or via e-mail, following the conditions below:

- i) 4 booths shall be accommodated in the stand (3 for the participants and one for the EPB). The partition walls between the two booths should be about 1.80m high.
- ii) Each booth shall be provided with 1 round table, 4 chairs, 10 open shelves, some hooks, 1 waste paper bin, floor covering, required graphics, electricity (including multiplug), and Sufficient lighting for each booth. EBP booth should have a television.
- iii) The design of the Bangladesh pavilion should highlight the colors of Bangladesh's national flag. However, the carpet would be any suitable color other than red and green.
- iv) The stand may also be provided with interior decoration. In addition, the stand builder must arrange a virtual group meeting with all co-exhibitors to discuss the stand design and their specific requirements. All wall designs and prints shall be produced by the stand builder; however, the design files for stickers/graphics must be provided by the co-exhibitors.
- v) The stand should be provided with storage space (Accessible from the EPB booth). The store space be provided with a door with a lock, a few shelves, a water kettle, a coffee machine, a fridge, and coat hooks/stand.
- vi) There would be a maximum of 03 names of participants and 1 lettering-Export Promotion Bureau (EPB) and 3 boards with the letter- BANGLADESH to be placed on three sides, which will be clearly visible from a distance.
- vii) The price of construction of the stand and supply of fixtures and furniture shall be quoted in terms of EURO/Square meter stating as well as the total price for the offer without VAT.
- viii) The stand should be ready for handing over on sight to the Commercial Counsellor, Bangladesh Embassy Berlin, on 12 January 2026, the days before the fair starts, in the forenoon.
- ix) The Embassy reserves the right to accept or reject any or all quotations without assigning any reason whatsoever.
- x) All payments will be made on receipt of invoices by bank transfer after the handing over of the stall to the Pavilion Director.

Encl: As stated

Yours Sincerely,

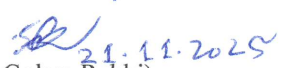
(Ch Md Golam Rabbi)
Commercial Counsellor
E-mail: berlin.cc@mincom.gov.bd

Standplan

Plan of the stand

heimtextil

13.01. - 16.01.2026

Export Promotion Bureau

1, Kawran Bazar (2nd, 4th & 9t
BD-1215 Dhaka

Messe Frankfurt Exhibition GmbH
Ludwig-Erhard-Anlage 1
60327 Frankfurt am Main

Telefon +49 69 75 75-0
Telefax +49 69 75 75-64 33
Fax on demand +49 69 25 70 01
www.messefrankfurt.com
info@messefrankfurt.com

Hinweise Remarks

Bei Datenfernübertragung (insb. Fax) sind Maßstabsabweichungen möglich.
Um das lichte Maß eines Reihenstandes zu erhalten, sind 5 cm von der Standbreite abzuziehen.
Die Messe Frankfurt Exhibition GmbH übernimmt keine Gewähr für die Richtigkeit der Maße. Alle Angaben sind vor Ort zu prüfen.

*Differences in scale are possible in the case of data transmission (especially fax).
In order to calculate the clear dimensions of stand in a row, 5 cm are to be deducted from the stand width. Messe Frankfurt Exhibition GmbH accepts no liability for the accuracy of the dimensions. All data and dimension must be checked on site.*

Legende Key

Versorgungskanal (Wasser / Abwasser, Strom, Telefon)

Utility channel (water / sewage, electricity, telephone)

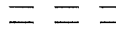

Wasserzufluß und -abfluß

Water supply and drainage



Deckentragschiene / Hängepunkte

Ceiling assembly rails / Suspension points



Säulen

Pillars



Messe Nr 260010000
Event No

Kunden Nr 10112260
Customer No

Stand Nr 9.1 H14
Stand No

Planstand: 13.08.2025

Änderungen vorbehalten / subject to change

Maßstab: 1 : 175

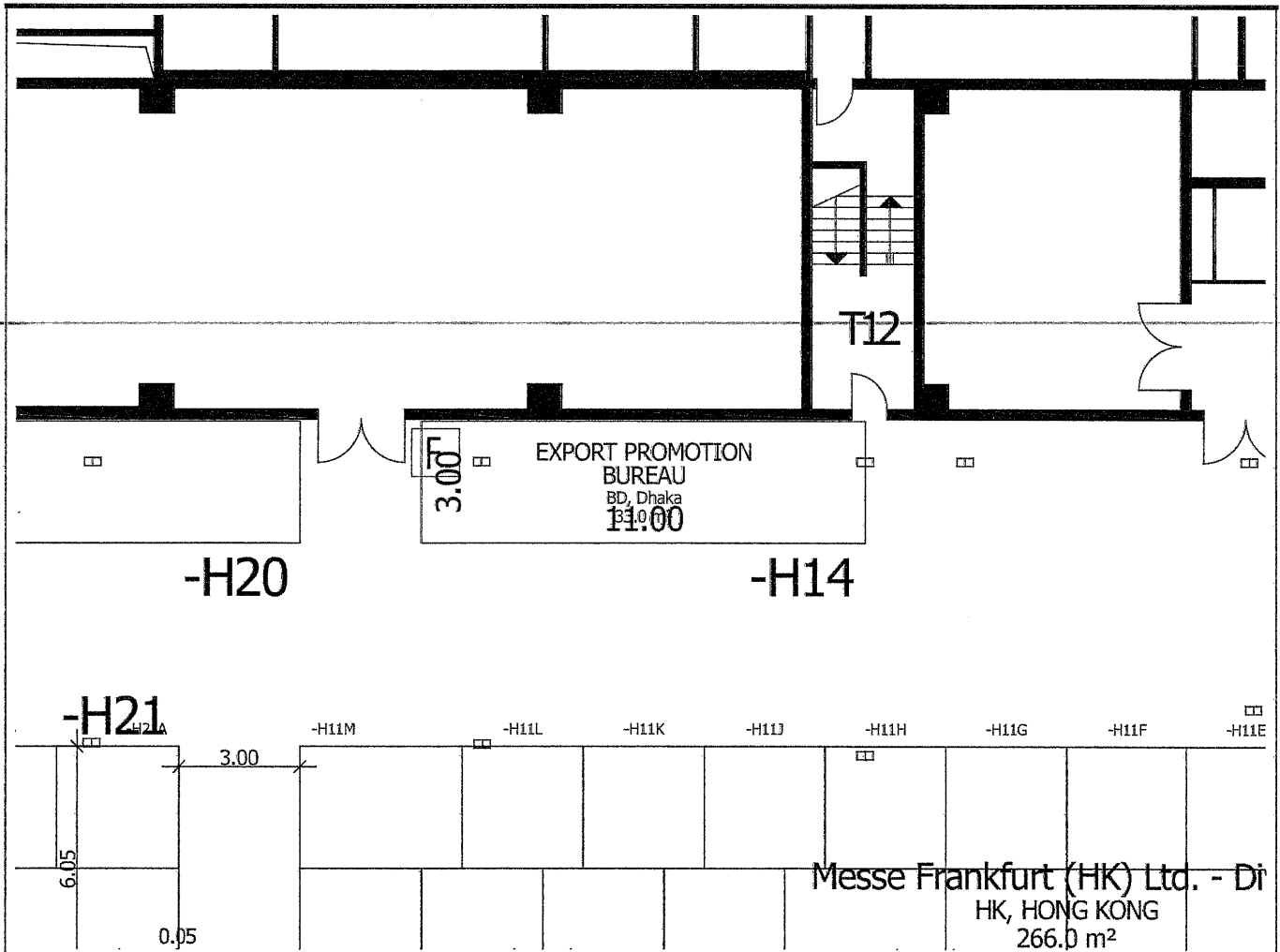

Messe Frankfurt (HK) Ltd. - Di
HK, HONG KONG
266.0 m²

Plotmaßstab 1 : 795

Heimtextil 2026
Vorläufiger Halleplan / Änderungen vorbehalten
Preliminary hall plan / Subject to modification

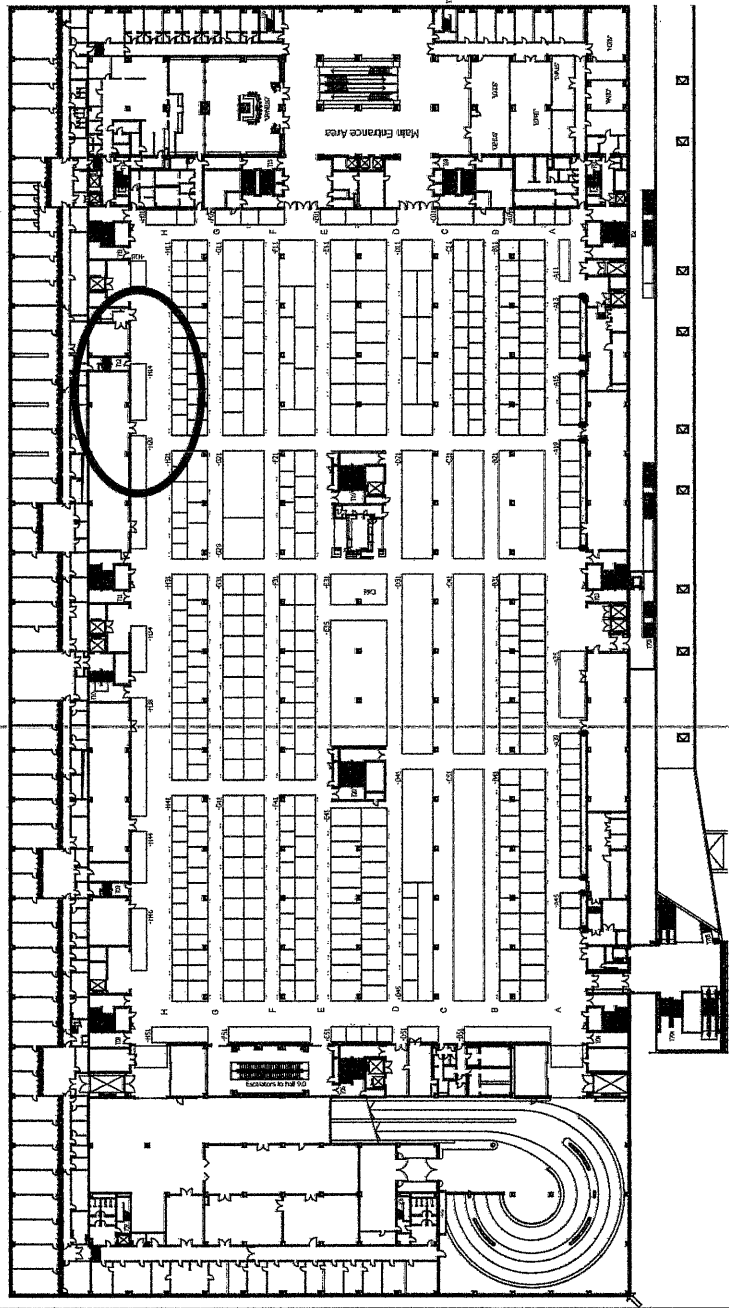

Legend	Legend
1	Booth
2	Booth
3	Booth
4	Booth
5	Booth
6	Booth
7	Booth
8	Booth
9	Booth
10	Booth
11	Booth
12	Booth
13	Booth
14	Booth
15	Booth
16	Booth
17	Booth
18	Booth
19	Booth
20	Booth
21	Booth
22	Booth
23	Booth
24	Booth
25	Booth
26	Booth
27	Booth
28	Booth
29	Booth
30	Booth
31	Booth
32	Booth
33	Booth
34	Booth
35	Booth
36	Booth
37	Booth
38	Booth
39	Booth
40	Booth
41	Booth
42	Booth
43	Booth
44	Booth
45	Booth
46	Booth
47	Booth
48	Booth
49	Booth
50	Booth
51	Booth
52	Booth
53	Booth
54	Booth
55	Booth
56	Booth
57	Booth
58	Booth
59	Booth
60	Booth
61	Booth
62	Booth
63	Booth
64	Booth
65	Booth
66	Booth
67	Booth
68	Booth
69	Booth
70	Booth
71	Booth
72	Booth
73	Booth
74	Booth
75	Booth
76	Booth
77	Booth
78	Booth
79	Booth
80	Booth
81	Booth
82	Booth
83	Booth
84	Booth
85	Booth
86	Booth
87	Booth
88	Booth
89	Booth
90	Booth
91	Booth
92	Booth
93	Booth
94	Booth
95	Booth
96	Booth
97	Booth
98	Booth
99	Booth
100	Booth

Booth No.	Booth Size (m²)	Booth No.	Booth Size (m²)
101	10	201	10
102	10	202	10
103	10	203	10
104	10	204	10
105	10	205	10
106	10	206	10
107	10	207	10
108	10	208	10
109	10	209	10
110	10	210	10
111	10	211	10
112	10	212	10
113	10	213	10
114	10	214	10
115	10	215	10
116	10	216	10
117	10	217	10
118	10	218	10
119	10	219	10
120	10	220	10
121	10	221	10
122	10	222	10
123	10	223	10
124	10	224	10
125	10	225	10
126	10	226	10
127	10	227	10
128	10	228	10
129	10	229	10
130	10	230	10
131	10	231	10
132	10	232	10
133	10	233	10
134	10	234	10
135	10	235	10
136	10	236	10
137	10	237	10
138	10	238	10
139	10	239	10
140	10	240	10
141	10	241	10
142	10	242	10
143	10	243	10
144	10	244	10
145	10	245	10
146	10	246	10
147	10	247	10
148	10	248	10
149	10	249	10
150	10	250	10

Scale: 1:795
 0 10 20 30 40 50 60 70 80 90 100
 m

© Messe Frankfurt 2026
 Alle Rechte vorbehalten.
 Nachdruck, Vervielfältigung und Verbreitung, auch auszugsweise, ist ohne schriftliche Genehmigung der Messe Frankfurt.

heimtextil
 13.01.-16.01.2026
 Halle 9 | Ebene 1
 Messe Frankfurt

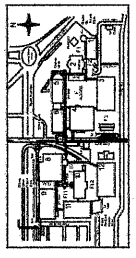

Wichtige Hinweise für die Besucher:
 Die Messe Frankfurt ist ein geschlossenes Gelände. Bitte beachten Sie die Anweisungen der Mitarbeiterinnen und Mitarbeiter der Messe Frankfurt. Bitte beachten Sie die Anweisungen der Mitarbeiterinnen und Mitarbeiter der Messe Frankfurt. Bitte beachten Sie die Anweisungen der Mitarbeiterinnen und Mitarbeiter der Messe Frankfurt.

Wichtige Hinweise für die Aussteller:
 Die Messe Frankfurt ist ein geschlossenes Gelände. Bitte beachten Sie die Anweisungen der Mitarbeiterinnen und Mitarbeiter der Messe Frankfurt. Bitte beachten Sie die Anweisungen der Mitarbeiterinnen und Mitarbeiter der Messe Frankfurt. Bitte beachten Sie die Anweisungen der Mitarbeiterinnen und Mitarbeiter der Messe Frankfurt.

Wichtige Hinweise für die Besucher:
 Die Messe Frankfurt ist ein geschlossenes Gelände. Bitte beachten Sie die Anweisungen der Mitarbeiterinnen und Mitarbeiter der Messe Frankfurt. Bitte beachten Sie die Anweisungen der Mitarbeiterinnen und Mitarbeiter der Messe Frankfurt. Bitte beachten Sie die Anweisungen der Mitarbeiterinnen und Mitarbeiter der Messe Frankfurt.

Lageplan

Halle + Stand-Nr.: 9.1 H14

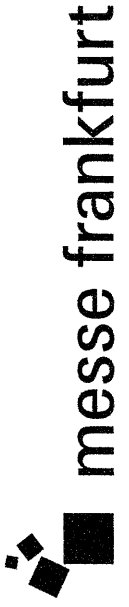

messe frankfurt